

FLOOR PLAN (EXISTING)

The plan below is a typical floor plan (ground floor) showing the spaces of the existing home (i.e. what the house looks like before the proposed extension).

When drawing a floor plan, it is important to show each rooms' name and dimensions, location of windows, doors and stairs and any section callouts for other associated plans.

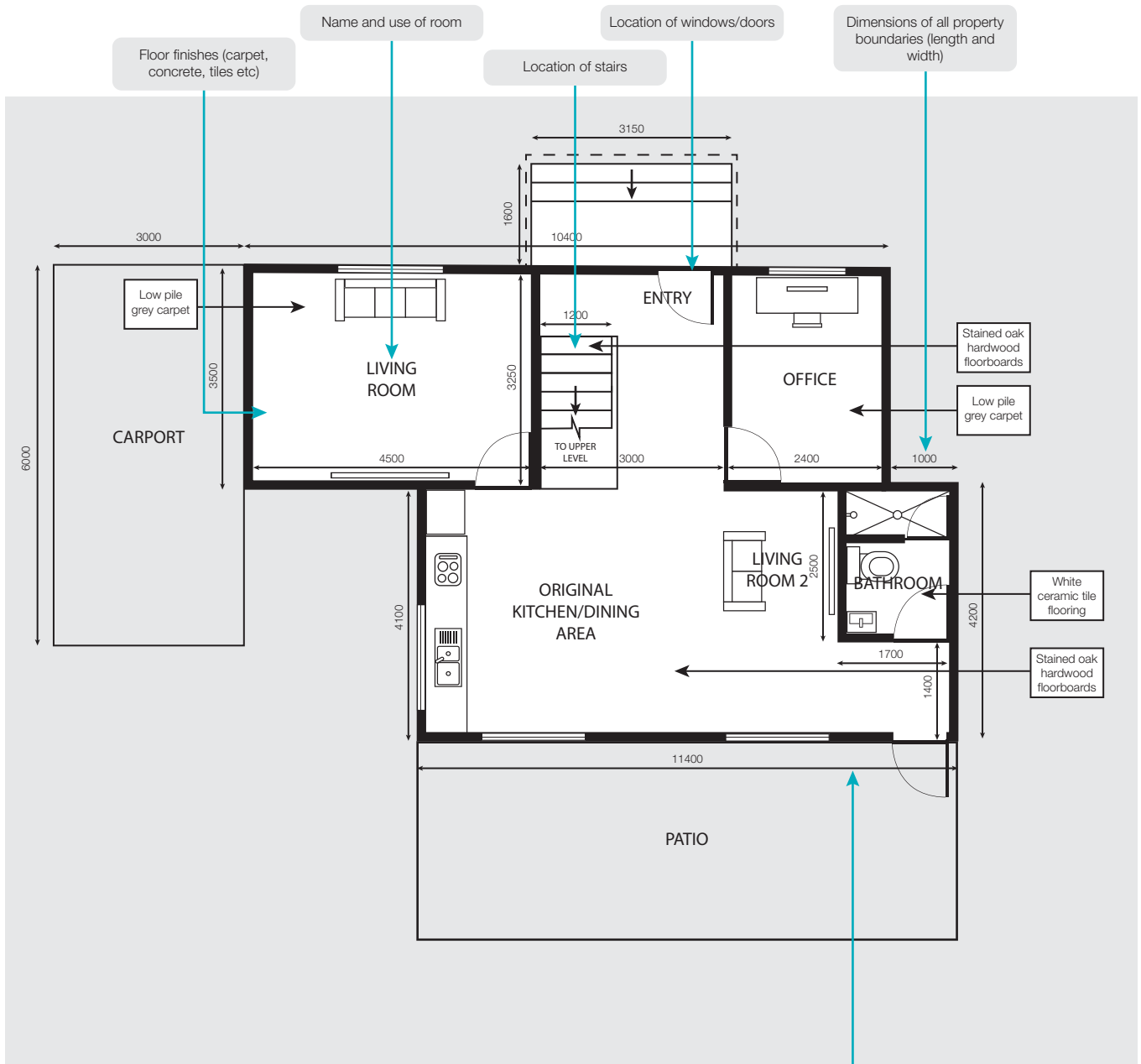

21 FLUID ST, ASPLEY QLD 4034	Drawn: John Appleseed	Original Floor Plan
	Scale: 1:100	

Scale

Dimensions of all property boundaries (length and width)